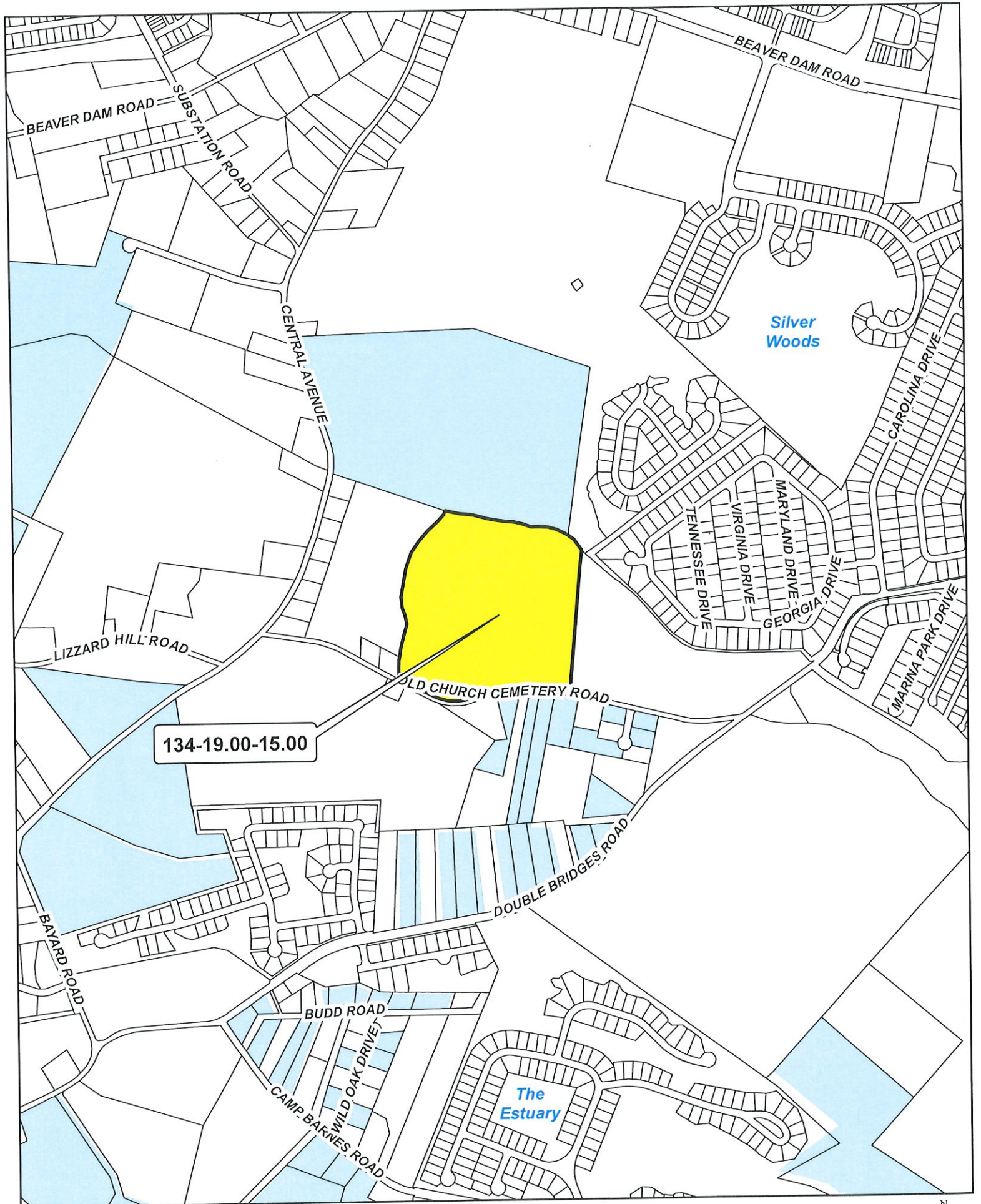



EXHIBIT A

OLDCHURCH15.00
PROPOSED PARCELS INCLUDED IN CPCN APPLICATION

	<u>PARCEL ID</u>	<u>PROPERTY ADDRESS</u>	<u>OWNER NAME</u>	<u>MAILING ADDRESS</u>	<u>ALLOCATION PERMIT</u>	<u>EXTENSION OF SERVICE</u>
1)	134-19.00-15.00	36219 Old Church Cemetery Rd	Dianne & Russell Archut	36219 Old Church Cemetery Road, Frankford, DE 19945	19-0143A (Armory Road)	Water service will be provided through a main extension connected to our regional water system. The Company is unable to estimate when it will provide service.



TP_13419001500w.mxd

 Existing AWC CPCN

Tax Parcel - 134-19.00-15.00



Artesian Water Company Water Service Petition

We the undersigned, request to be included in the water service territory of Artesian Water Company, Inc. for the following property in Sussex County, Delaware.

Parcel Nos.: 134-19.00-15.00

Property Description: N/RT 367 1000'
E/RT 84

Property Owner(s): ARCHUT DIANNE H & RUSSELL W

Signature: Dianne H. Archut Title: Owner Date: 9/5/2019

Printed: Dianne H. Archut

Address: 36219 Old Church Cemeteryrd Telephone 302-245-3054
Frankford DE 19945

Signature: Russell W. Archut Title: Owner Date: 9/5/2019

Printed: Russell W. Archut

Address: 36219 Old Church Cemetery Telephone (302) 245-3053
Frankford DE 19945

All legal owners of the parcel must sign for the petition to be valid.

For parcels owned by individuals simply indicate owner as title.

For parcels owned by corporations, LLC's or other entities, please provide documentation of the signer's authorization.

I UNDERSTAND THAT BY SIGNING THIS PETITION MY PROPERTY MAY HAVE TO REMAIN IN ARTESIAN WATER COMPANY, INC'S SERVICE TERRITORY PERMANENTLY. I ALSO UNDERSTAND THAT IT MAY AFFECT MY ABILITY TO OBTAIN A PERMIT FOR A NEW WELL.

IF YOU HAVE ANY QUESTIONS, COMMENTS, OR CONCERNS, PLEASE CONTACT THE PUBLIC SERVICE COMMISSION AT (302) 736-7500 (in Delaware, call 800-282-8574).

Return to:
Artesian Water Company, Inc.
664 Churchmans Road
Newark, DE 19702 Attn: Stephen Joswick

PARID: 134-19.00-15.00
 ARCHUT DIANNE H

ROLL: RP
 36219 OLD CHURCH CEMETERY RD

Property Information

Property Location: 36219 OLD CHURCH CEMETERY RD
 Unit:
 City: FRANKFORD
 State: DE
 Zip: 19945

Class: AGR-Agriculture
 Use Code (LUC): AH-AG W/ HOMESITE
 Town: 00-None
 Tax District: 134 – BALTIMORE
 School District: 1 - INDIAN RIVER
 Council District: 5-Rieley
 Fire District: 84-Millville
 Deeded Acres: 39.2700
 Frontage: 0
 Depth: .000
 Irr Lot:
 Zoning 1: GR-GENERAL RESIDENTIAL
 Zoning 2: -
 Plot Book Page: /PB

100% Land Value: \$6,700
 100% Improvement Value: \$69,400
 100% Total Value: \$76,100

Legal

Legal Description: N/RT 367 1000'
 E/RT 84

Owners

Owner	Co-owner	Address	City	State	Zip
ARCHUT DIANNE H	RUSSELL W	36219 OLD CHURCH CEMETERY RD	FRANKFORD	DE	19945



100 YEARS OF SUPERIOR SERVICE

- ▲ Artesian Water Company, Inc.
- ▲ Artesian Wastewater Management, Inc.
- ▲ Artesian Utility Development, Inc.
- ▲ Artesian Water Maryland, Inc.

664 Churchmans Road, Newark, Delaware 19702
P.O. Box 15004, Wilmington, Delaware 19850

Dianne H. Archut &
Russell W. Archut
36219 Old Church Cemetery Rd
Frankford, DE 19945

ENCLOSED IS IMPORTANT
INFORMATION FROM THE PUBLIC
SERVICE COMMISSION THAT
AFFECTS YOUR RIGHTS REGARDING
WATER SERVICE

7018 2290 0002 0428 1772

YOU SHOULD READ THIS NOTICE CAREFULLY

Public records list you as a landowner of the property with the following tax map parcel identification number(s): 134-19.00-15.00. Within thirty-five (35) days, Artesian Water Company, Inc. plans to file an application with the Delaware Public Service Commission requesting a Certificate of Public Convenience and Necessity (Certificate) to provide water service to a new territory described as OLDCHURCH15.00.

ARTESIAN WATER COMPANY, INC. HAS INCLUDED YOUR PROPERTY IN THE TERRITORY IT INTENDS TO SERVE. ARTESIAN WATER COMPANY, INC IS ABLE TO PROVIDE WATER SERVICE TO YOUR PROPERTY IN THE FUTURE THROUGH A MAIN EXTENSION CONNECTED TO OUR REGIONAL WATER SYSTEM. ARTESIAN WATER COMPANY, INC. IS UNABLE TO ESTIMATE WHEN IT WILL PROVIDE WATER SERVICE TO YOUR PROPERTY.

IF YOU DO NOT TAKE ANY ACTION NOW, YOU MAY LOSE YOUR CHOICE OF WHO CAN PROVIDE WATER SERVICE TO YOUR PROPERTY AND WHETHER YOU CAN OBTAIN A WELL PERMIT.

- 1) **You may choose to be included in the utility's proposed service territory. If you signed a petition for water service asking to be included in the utility's proposed service territory, or, if you did not sign a petition for water service but want to be included, you do not have to take any action.**
- 2) You have the right to "opt-out" of the utility's proposed service territory. If you "opt-out", your property will not be included in the utility's service territory. You can do this even though others might desire water service from the utility. **You should understand that being included in a utility's service territory does not mean that public water service will be immediately available to your property or that, when available, you will be required to hook-up to the public water system.** However, if your property is included in the utility's water service territory, and later the water from the well providing your drinking water cannot be used, the Department of Natural Resources and Environmental Control might deny you a permit for a new well if public water is available to your property. On the other hand, if you elect to "opt-out" of the utility's service territory, but later change your mind and decide to connect to the utility's public water system, you could be charged additional fees.
- 3) You may object to the Public Service Commission granting a Certificate for OLDCHURCH15.00. For example, you may object that the water utility does not have the legal right to serve the territory. You should review the law about what a utility must provide in order to obtain a Certificate (contact the Public Service Commission to obtain a copy of the law). If you file such an objection, you will need to tell the Public Service Commission why the utility should not receive the Certificate. Please note that an objection will not remove your property from a proposed service territory. To remove your property from the service territory, you must request to "opt-out."

Attached to this letter is a form which allows you (and other owners of the property) to exercise your options. You have seventy-five (75) days from your receipt of this notice to file your objection with the Commission. Although you may exercise your right to "opt-out" of the utility's service territory at any time before the Certificate is granted, if you choose to opt-out, it is requested that you complete the form and return it to the Public Service Commission at the address listed below within seventy-five (75) days from the date you receive this notice:

Delaware Public Service Commission 861 Silver Lake Boulevard
Cannon Building, Suite 100
Dover, Delaware 19904

If you want to "opt-out" or object, you must send the completed form to the Public Service Commission, even if you already informed the utility of your intent to "opt-out" or object.

If you have any questions, comments or concerns, please contact the Public Service Commission at (302) 736-7500 (in Delaware, call 800-282-8574).

PROPERTY OWNER OPT-OUT/OBJECT FORM

Delaware Public Service Commission
861 Silver Lake Boulevard
Cannon Building, Suite 100
Dover, Delaware 19904

Dear Delaware Public Service Commission:

I/We are the recorded property owner(s), according to current tax records, for the following property/properties:

Tax Map Parcel Identification Number(s): 134-19.00-15.00

We received a notice from Artesian Water Company, Inc. that it plans to file an application with the Delaware Public Service Commission for a Certificate of Public Convenience and Necessity (Certificate) to provide water service to a proposed service territory described by Artesian Water Company, Inc. as OLDCHURCH15.00 (hereafter, "Proposed Service Territory").

_____ As permitted by applicable law, I hereby opt-out of Artesian Water Company, Inc.'s proposed service territory. I understand that by opting out of the Proposed Service Territory, I may be charged additional fees if I later change my mind and choose to be included in the Proposed Service Territory and receive water service from Artesian Water Company, Inc.

_____ I hereby object to the Artesian Water Company, Inc.'s application for the Certificate of Public Convenience and Necessity. I understand that by objecting to the Artesian Water Company, Inc.'s application I am not merely objecting to being included in the Proposed Service Territory (in which case, I may merely opt out as permitted by electing to opt out above), but rather am objecting to the Commission authorizing the Artesian Water Company, Inc. to provide water service to *any territory* within the Proposed Service Territory, including, but not limited to, my own property. The basis of my objection is as follows:

Property Owner(s): *[Property Owner Name]* _____
 [Property Owner Address] _____

Owner's Signature: _____ Date: _____

**U.S. Postal Service™
CERTIFIED MAIL® RECEIPT**
Domestic Mail Only

For delivery information, visit our website at www.usps.com®.

OFFICIAL USE

2222 9240 2000 0622 9702

Certified Mail Fee

Extra Services & Fees (check box, add fee as appropriate)

- Return Receipt (hardcopy) \$
- Return Receipt (electronic) \$
- Certified Mail Restricted Delivery \$
- Adult Signature Required \$
- Adult Signature Restricted Delivery \$

Postage

Total Postage and Fees

Sent to DIANNE H. ARCHUT + RUSSELL W. ARCHUT
 Street and Apt. No., or PO Box No. 36219 OLD CHURCH CEMETERY RD
 City, State, Zip+4 FRANKFORD, DE 19945
 PS Form 3800, April 2015 PSN 7530-02-000-9047 See Reverse for Instructions



SENDER: COMPLETE THIS SECTION

- Complete items 1, 2, and 3.
- Print your name and address on the reverse so that we can return the card to you.
- Attach this card to the back of the mailpiece, or on the front if space permits.

1. Article Addressed to:

DIANNE H. ARCHUT +
RUSSELL W. ARCHUT
36219 OLD CHURCH CEMETERY RD
FRANKFORD, DE 19945



9590 9402 4507 8278 7161 46

2. Article Number (Transfer from service label)

7018 2290 0002 0428 1772

PS Form 3811, July 2015 PSN 7580-02-000-9063

COMPLETE THIS SECTION ON DELIVERY

A. Signature

X JT US/CLIS Agent Addressee

B. Received by (Printed Name)

DIANNE H. ARCHUT Date of Delivery

C. Date of Delivery

JUN 1 - 2020 Yes No

D. Is delivery address different from item 1? Yes No

If YES, enter delivery address below:

FRANKFORD, DE 19945

3. Service Type

- Adult Signature
- Adult Signature Restricted Delivery
- Certified Mail®
- Certified Mail Restricted Delivery
- Collect on Delivery
- Insured Mail
- Priority Mail Express®
- Registered Mail™
- Registered Mail Restricted Delivery
- Return Receipt for Merchandise
- Signature Confirmation™
- Signature Confirmation Restricted Delivery

Domestic Return Receipt

Certification of Landowner Information Accuracy

I certify that I received appropriate tax or land documents which verify that the individuals in this Application are either landowners of record or agents authorized to act on behalf of entities that control the parcel(s) included in this CPCN Application. I certify that the petitions to provide water service to parcel(s) noted in this Application have been signed by landowners or by dually authorized agents.



Scott W. Stephan